

DALI Switch Actuator

Model No: LR04CD

Profile

- High-power switch actuator can achieve high power switching control through DALI signal input
- 4 channels with single loop max output power reach to 20A
- High-power magnetic latching relays

Features

- Applicable for standard DALI signal and other inductive loads
- High-power magnetic latching relays, no power consumption
- Power consumption, anti-surge current > 170A
- Long life cycle, small size and DIN-rail installation, easy to install
- Relay manual operation is optional
- White or black metal shell



Technical Parameters

Model No	LR04CD	LR06CD	LR08CD	LR12CD
Brand	LAMMIN			
Input Signal	DALI signal			
Input Voltage	AC 220V			
Frequency Range	50/60Hz			
Max Load Current	20A/CH*4	20A/CH*6	20A/CH*8	20A/CH*12
Max Output	20A 250VAC,4000W, 3*10 ⁴ (fluorescent lamp)5HP 250VAC 3*10 ⁴ (motor load)			
Min Load	60W			
Certification	CE			
Working Temp	-20°C~ +50°C			
Warranty	3 years			
Size(L*W*H)MM	72*92*65	144*92*65	144*92*65	216*92*65
Installation	35MM Din-rail			
Customization	YES			

Wiring Diagram and Installations

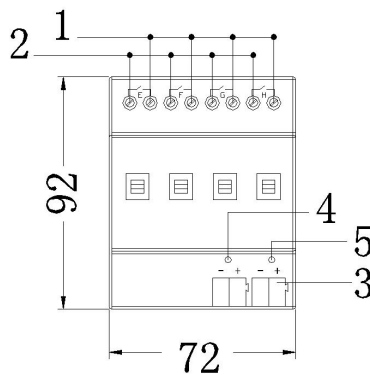
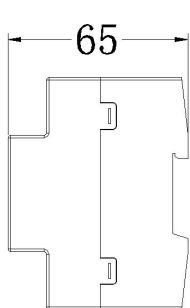

- 1)Output terminal
- 2)Input terminal
- 3)EIB terminal
- 4)Programming button
- 5)Working indicator