

LED Dimming DC Power Supply Specification



版本: A2

产品图: Product figure 	产品型号 (认证) / Product model:	类型: <input type="checkbox"/> 恒压驱动器 (Model) Constant current driver
	产品品号 P/N:	<input type="checkbox"/> 调光驱动器 ✓ Dimmer driver
	产品名称/Name: WIZ 5 通道恒压 DC 调光器	<input type="checkbox"/> 其他电源产品 Others
	产品来源/Source: <input type="checkbox"/> Homemade ✓ <input type="checkbox"/> OEM <input type="checkbox"/> ODM <input type="checkbox"/> Others	
产品特点或描述: Product description: LED 灯带调光电源通过输入 WIZ 调光信号, 来控制大功率的 LED 灯带 R, G, B, CW, WW 5 路调光器的输出功率可以达到 300W, 采用高频率 PWM 控制, 调光输出平滑, LED 灯带无闪烁; 具有消除电源浪涌设计, LED 灯带工作稳定, 寿命长。 LED lamp belt with dimming power supply control the high power lamp belt with R, G, B, CW, WW 5-way dimmer by WIZ dimming signal input, output power can reach 200W, using high frequency PWM control, dimming output smooth, LED light without flicker, with the design of eliminating power surge, the LED lamp belt works stably and has a long life span.		
输入特性 Input	输入电压范围/ Voltage range	12-36V DC
	输入电流范围/ Current range	15A

	功率因素 / Power factor	-----		
	输入电压总谐波 /V THD	-----		
	电源效率 / Efficiency (Typ.)	-----		
输出特性 Output	额定输出电压范围/ Rated DC voltage	12-36V 随输入电源		
	空载电压 / No-load voltage	12-36V 随输入电源		
	额定输出电流/ Rated current	15A (回路总和) Total		
	额定输出功率/ Rated Power	300W		
	输出纹波噪声/ Ripple & Noise	----		
	负载调整率 / Load regulation	---		
	额定负载 / Rated Load	300W		
保护特性 Protection	防浪涌电压保护/Surge voltage protection	<input type="checkbox"/> 无 <input type="checkbox"/> 500V <input type="checkbox"/> 1000V <input checked="" type="checkbox"/> 1500V		
	输出短路保护/ Short circuit	如任何一个回路, 电流超过 15A 或者输出短路, 电源自动锁死, 需断电恢复。/ If the current exceeds 15A or the output is short circuit, the power supply will automatically lock up and need to be restored by power cut.		
	输出开路保护/ Open circuit			
	过温保护/ Over TEMP.	---		
环境特性 Environment	工作环境温度/ Working TEMP.	-20~+50°C		
	存储温度 / Storage TEMP.	-30~+85°C		
	防水等级 / Working Humidity	---		
安全特性 Safety	绝缘电阻 / Insulation Resistance	I/P-O/P: /P-FG 100M		
	介电强度 /Voltage Resistance Test	I/P-O/P:1.5KV I/P-FG1.5KV/P-FG:0。		
符合标准 Standard	安全标准 /SafetyStandard	IEC60950-1 CCC, GB4943. 申请中		
	性能标准 /Performance Standard	---		
	电磁兼容 / EMC			
寿命 Life	平均无故障时间/ MTBF	25,000hours (25°C)		
包装 Package	产品尺寸 Product Size	155X47X19MM	包装尺寸 Package Size	160X53X22mm
	外箱材积 Carton volume	____件/箱	产品净重 Product net weight	0.32KG
	产品毛重 Product gross weight	0.3KG	整箱毛重 Package gross weight	

附件

外形尺寸图

Drawing

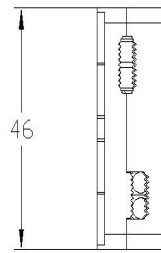
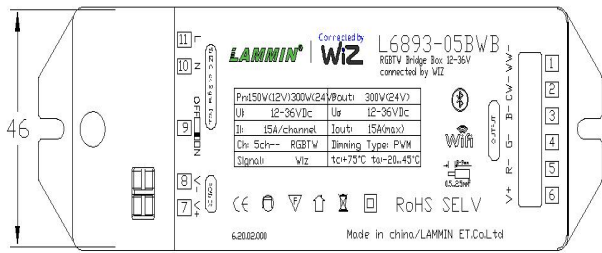
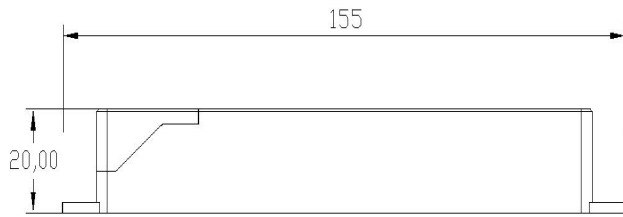

- 1) Warm white output
- 2) Cold white output
- 3) B output
- 4) G output
- 5) R output
- 6) Output V+
- 7) Input V+
- 8) Input V-
- 9) WIZ click on-off switch
- 10) Power L; N only for WIZ click

接线示意图

Wiring diagram

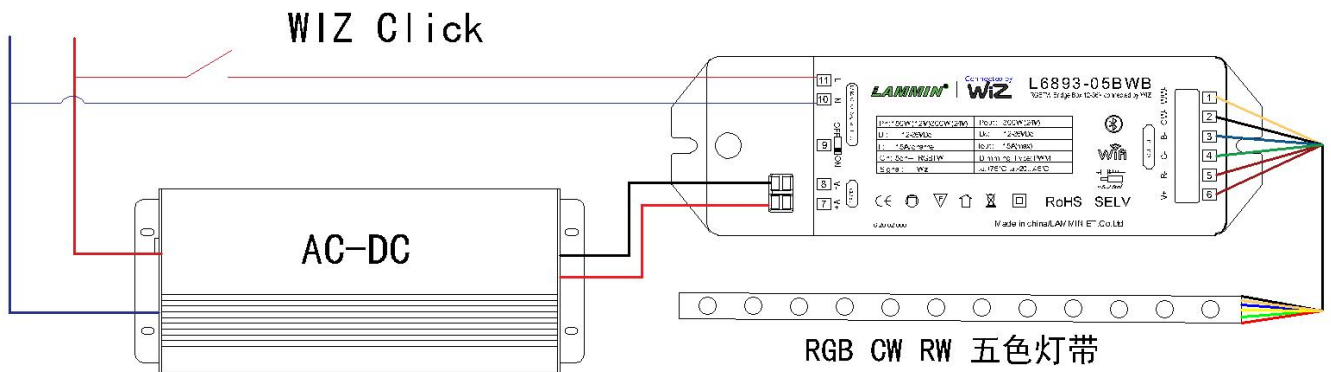

安全注意事项 Safe use and maintenance

- 使用前详细阅读所有相关说明。Please perusal the instructions before use.
- 安装在天花板或者灯体内，稳固固定。Ceiling installation or build-in installation.
- 按照所标示功率、禁止超负荷使用。According to the marked power, overload shall be forbidden
- 严禁水，易燃或腐蚀性液体、气体，金属粉末物质进入该设备。 It is forbidden to water, flammable or corrosive liquid, gas, metal powder material