

KNX Switch Actuator

Model No: LR08CK

Profile

- High-power switch actuator can achieve high power switching control through KNX signal.
- 8 channels with single loop max output power reach to 20A
- High-power magnetic latching relays
- Two dry contact input signals and one 24V input signals

Features

- Applicable for standard KNX signal and other inductive loads
- High-power magnetic latching relays, no power consumption
- Power consumption, anti-surge current > 170A
- Long life cycle, small size and DIN-rail installation, easy to install
- Relay manual operation is optional
- White or black metal shell



Technical Parameters

Model No	LR08CK	LR04CK	LR06CK	LR12CK
Brand	LAMMIN			
Input Signal	KNX signal			
Input Voltage Range	EIB/KNX DC30V			
Frequency Range	50/60Hz			
Max Load Current	20A/CH*8	20A/CH*4	20A/CH*6	20A/CH*12
Max Output	20A 250VAC,4000W, 3*10 ⁴ (fluorescent lamp)5HP 250VAC 3*10 ⁴ (motor load)			
Min Load	60W			
Certification	CE			
Working Temp	-20°C~ +50°C			
Warranty	3 years			
Size(L*W*H)MM	144*90*65	72*88*65	107*90*65	216*88*65
Installation	35MM Din-rail			
Customization	YES			

Wiring Diagram and Installations

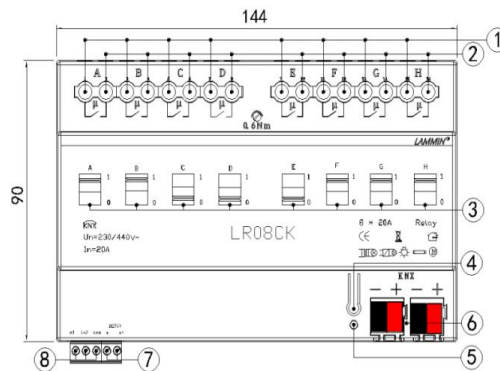
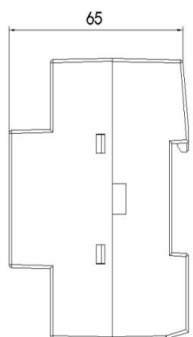

- 1) Input ports 1-8
- 2) Output ports 1-8
- 3) 1-8 manual dip switches
- 4) Programming button
- 5) Programming indicator
- 6) EIB BUS terminals
- 7) Input port 1 way 24V signal
- 8) Input port 2 dry contact